

TRAINING 2021 GUIDE



CAMO[®]
The Better Way to Build a Deck

CAMO products are user-friendly, intuitive, and are designed to give you the best experience. To ensure you're confident in every install, we put together this comprehensive Training Guide full of the information you need to build better.

In this guide, we break down the components of CAMO tools, guide you on setting them up, and give you simple instructions for every install. Towards the back of the guide, we included a resources section full of information about fastening in special cases, best practices to follow, and cover troubleshooting.

Look through this Training Guide to get ready for your install, and you'll see why CAMO is the better way to build a deck.

CONTENTS

PRODUCT OVERVIEW	4
DRIVE	6
EDGE	8
CLIP	10
FACE	12
UNIVERSAL DECK CLIPS	14
STARTER	16
EDGE	18
EDGEX	20
EDGEXMETAL	22
LEVER	24
BENDING BOARDS	26
LOCKING BOARDS	28
MARKSMAN SYSTEM	30
MARKSMAN PRO TOOLS	32
MARKSMAN EDGE	34
EXTERIOR	36
RESOURCES	38
SPECIAL CASES - EDGE FASTENING	39
BEST PRACTICES FOR EDGE FASTENING	41
SPECIAL CASES - CLIP FASTENING	42
MARINE ENVIRONMENTS	46
TROUBLESHOOTING	47

DRIVE™ System

DRIVE™



T-15 BIT



T-20 BIT



INTERCHANGEABLE NOSE PIECES

COLLATED SCREWS

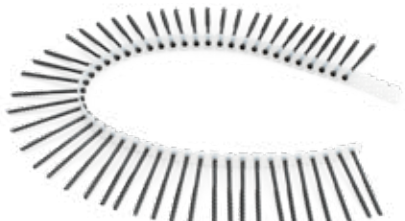

COLLATED EDGE SCREWS



COLLATED WOOD FACE SCREWS



COLLATED COMPOSITE FACE SCREWS

UNIVERSAL DECK CLIPS



STARTER



EDGE*



EDGEX*



EDGEXMETAL*



NEVER-MISS™ GUIDE

MARKSMAN® System

MARKSMAN TOOLS



MARKSMAN PRO®



MARKSMAN PRO®-X1



MARKSMAN PRO®-NB



MARKSMAN® EDGE

EDGE SCREWS



PROTECH



STAINLESS STEEL

MARKSMAN ACCESSORIES



BIT FOR SQUARE BOARDS



BIT FOR GROOVED BOARDS



PRE-DRILL BIT

LEVER®



Exterior Screws

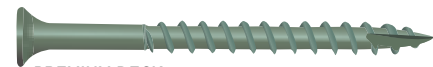

PREMIUM DECK



COMPOSITE



PREMIUM TRIM



STRUCTURAL

DRIVE™

Stand up, save your back and knees, and save your time with the award-winning CAMO® DRIVE™ system. The DRIVE tool can be used to fasten almost any board* while comfortably standing up. DRIVE is for exclusive use with CAMO Universal Deck Clips, and CAMO Collated Edge and Face Screws.

DRIVE	7
EDGE	8
CLIP	10
FACE	12

Get to know your *DRIVE* tool

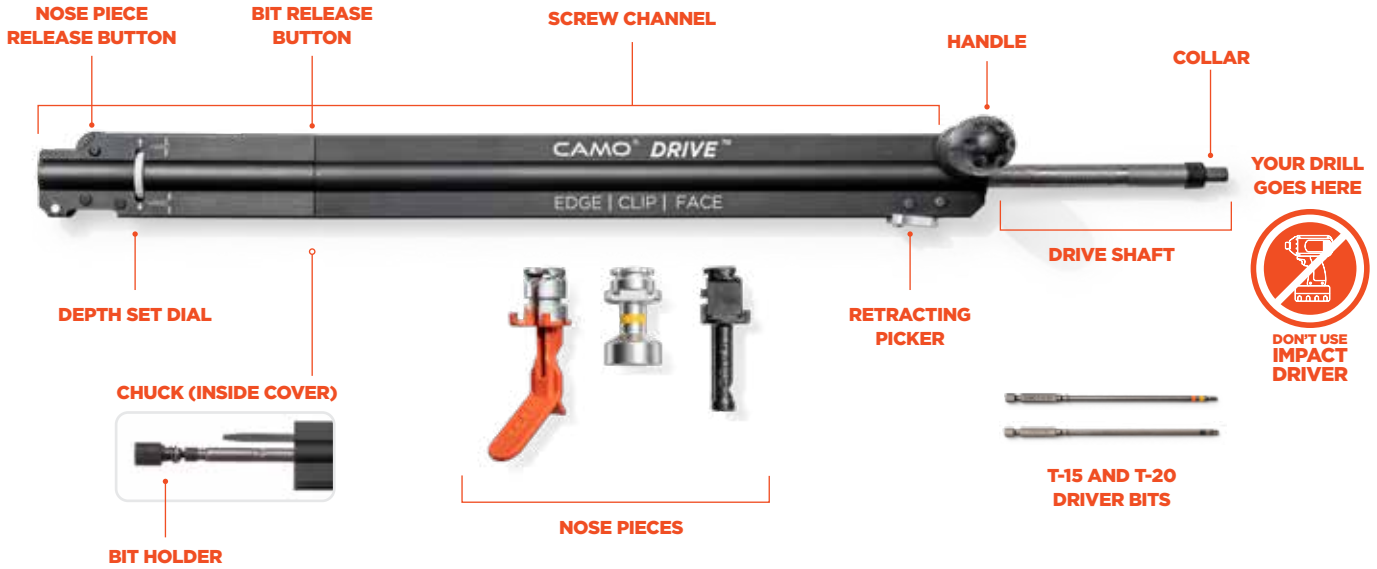

SELECT A NOSE PIECE

	EDGE	CLIP	FACE
Nose Piece			
How It Works			
Compatible Board Profiles	Square	Grooved	Square
Compatible Deck Boards	Pressure Treated Composite PVC Cedar Redwood	Composite PVC Capped Composite Hardwood	Pressure Treated Composite PVC Capped Composite
Compatible Fasteners	Collated Edge Screws	Universal Deck Clips	Collated Composite and Wood Face Screws

*We do not recommend using the DRIVE tool to Edge fasten capped composites or hardwood as these boards need to be pre-drilled. Instead, use the MARKSMAN Pro® Tool and Edge Screws (p. 31).

ASSEMBLE THE TOOL



INSTALL HANDLE

Attach the handle by screwing it onto the bolt at the top of the tool. You can reverse the handle for right or left-handed use by simply loosening the bolt and reinstalling it on the other side of the tool.

Setup for Edge fastening



A INSTALL T-15 DRIVER BIT



Using a bit, press the release button in the channel and remove the lower body of the tool.



Position the tool body so the large collar of the drive shaft is on a stable surface.



Pull the body of the tool back with one hand to reveal the bit holder. Continue to hold in place.



Put the T-15 bit in your other hand, pull down on the bit holder, and set the bit in place.



Pull up on the bit holder to ensure the bit is locked in.



Slide the lower tool body over the bit—it will click into position.

B INSERT EDGE NOSE PIECE



Press the release button.



Insert the Edge nose piece. It will lock into place.

C ATTACH YOUR DRILL



Make sure the drill is set in the forward position. Insert the large collar of the drive shaft into the drill chuck and tighten.



Set your drill to its highest torque setting.

D INSERT SCREW STRIP



Slide the collated screw strip into the screw strip channel.



Push the strip through the nose piece.



Slide the picker up.



Push the end of the strip into the picker teeth.

E TEST & ADJUST SCREW HEIGHT



Before fastening on the deck top, drive a few screws into a scrap piece of material and adjust the depth set dial accordingly. For Edge screws, sink them 1/8-1/4 in. below the surface of the deck board.

How to Edge fasten

BEFORE YOU BEGIN

Where Edge fastening with the DRIVE isn't possible, use CAMO Premium Deck or Composite Screws. Go to page 39 for full instructions.

1



POSITION NOSE PIECE

Starting on the outer edge of the board, line up the nose piece with the joist at least 1 in. from the board end.

2



ENGAGE DRILL

With the nose piece flat on the surface of the board, and pressure on the DRIVE handle, run the drill at full speed, and push the driver drill down to engage the bit and screw.

3



FASTEN THE BOARD

Apply steady pressure, but do not force the screw—it will auger the surface on its own. Continue driving until the drill is fully compressed and the depth release disengages.

4



LIFT DRIVE UP

After fastening, lift up on the DRIVE tool to return your drill to starting position. The screw will automatically advance.

5



FASTEN EVERY JOIST

Install a screw at every joist on the outer edge of the board.

6



REPEAT ON OTHER SIDE OF THE BOARD

Follow the same steps to fasten the inside edge of the board.

Setup for Clip fastening



A INSTALL T-15 DRIVER BIT



Using a bit, press the release button in the channel and remove the lower body of the tool.



Position the tool body so the large collar of the drive shaft is on a stable surface.



Pull the body of the tool back with one hand to reveal the bit holder. Continue to hold in place.



Put the T-15 bit in your other hand, pull down on the bit holder, and set the bit in place.



Pull up on the bit holder to ensure the bit is locked in.



Slide the lower tool body over the bit—it will click into position.

B INSERT CLIP NOSE PIECE



Press the release button.



Insert the Clip nose piece. It will lock into place.

C ATTACH YOUR DRILL



Make sure the drill is set in the forward position. Insert the large collar of the drive shaft into the drill chuck and tighten.



If your drill has a drill and clutch mode, set it to clutch mode. Set your drill to 30% of maximum torque.

How to Clip fasten



BEFORE YOU BEGIN

Lay down rows of boards and clips and hold or lock them in place.



1 POSITION NOSE PIECE

Starting at the outermost board, place the Clip nose piece over the exposed screw.



2 ENGAGE DRILL

With the nose piece flat on the surface of the board, and pressure on the DRIVE handle, run the drill at full speed, and push the driver drill down to engage the bit and screw.



3 FASTEN THE BOARD

Apply steady pressure and continue to drive until the drill clutch releases.



4 LIFT DRIVE UP

After fastening, lift up on the DRIVE tool to return your drill to starting position.



5 FASTEN EVERY JOIST

Fasten all of the remaining clips at each joist.

**FIND MORE SPECIFIC INFORMATION ABOUT EACH CLIP TYPE ON PAGES 15-23.*

Setup for Face fastening



A INSTALL T-20 DRIVER BIT



Using a bit, press the release button in the channel and remove the lower body of the tool.



Position the tool body so the large collar of the drive shaft is on a stable surface.



Pull the body of the tool back with one hand to reveal the bit holder. Continue to hold in place.



Put the T-20 bit in your other hand, pull down on the bit holder, and set the bit in place.



Pull up on the bit holder to ensure the bit is locked in.



Slide the lower tool body over the bit—it will click into position.

B INSERT FACE NOSE PIECE



Press the release button.



Insert the Face nose piece. It will lock into place.

C ATTACH YOUR DRILL



Make sure the drill is set in the forward position. Insert the large collar of the drive shaft into the drill chuck and tighten.



Set your drill to its highest torque setting.

D INSERT SCREW STRIP



Slide the collated screw strip into the screw strip channel.



Push the strip through the nose piece.



Slide the picker up.



Push the end of the strip into the picker teeth.

E TEST & ADJUST SCREW HEIGHT



Before fastening on the deck top, drive a few screws into a scrap piece of material and adjust the depth set dial accordingly. For Face screws, you can drive them flush or countersink them.

How to Face fasten



1



POSITION NOSE PIECE

Starting on the outer edge of the board, line up the nose piece with the joist at least 1 in. from the board end and edge.

2



ENGAGE DRILL

With the nose piece flat on the surface of the board, and pressure on the DRIVE handle, run the drill at full speed, and push the driver drill down to engage the bit and screw.

3



FASTEN THE BOARD

Apply steady pressure, but do not force the screw—it will auger the surface on its own. Continue driving until the drill is fully compressed and the depth release disengages.

4



LIFT DRIVE UP

After fastening, lift up on the DRIVE tool to return your drill to starting position. The screw will automatically advance.

5



FASTEN EVERY JOIST

Install two screws at every joist until the entire board is installed.

UNIVERSAL DECK CLIPS

CAMO Universal Deck Clips make installing grooved decking on wood and metal joists easy for everyone. These hidden deck clips are designed and warranted for use with leading grooved decking and result in a beautiful fastener-free surface that you can install in half the time of other hidden fasteners. Fasten EDGE®, EDGEX®, and EDGEXMETAL® Clips by hand with the included NEVER-MISS™ Guide, or standing up with DRIVE.

INTRODUCTION	15
STARTER	16
EDGE	18
EDGEX	20
EDGEXMETAL	22

Get to know your Clips

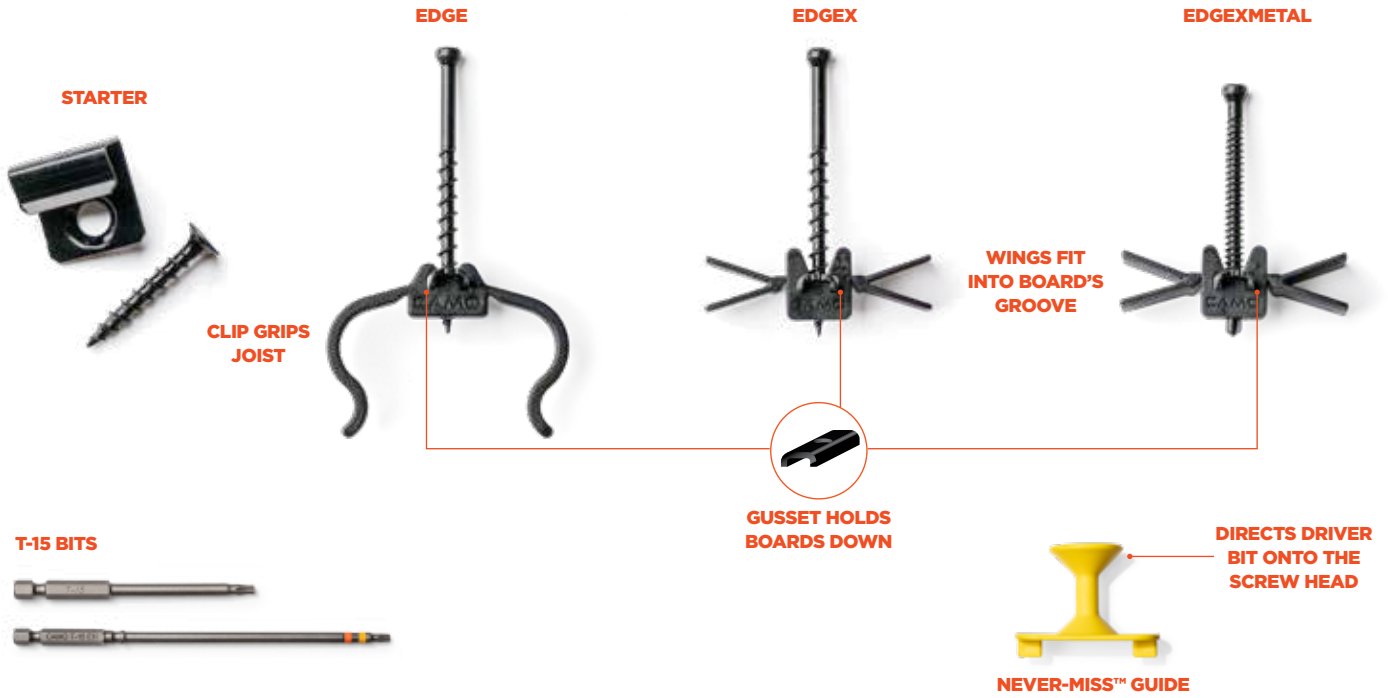

WHICH CLIPS SHOULD I USE?

CLIP TYPE	90° PATTERNS	ANY PATTERN
	STARTER CLIPS	✓
EDGE CLIPS	✓	X
EDGEX CLIPS	✓	✓
EDGEXMETAL CLIPS	✓	✓

GROOVED BOARD TYPE	
COMPOSITE	✓
PVC	✓
CAPPED COMPOSITE	✓
HARDWOOD	✓

Setup for STARTER Clips



A INSERT T-15 BIT



Insert the T-15 driver bit into your drill. Do not use an impact driver.

B ADJUST DRILL



If your drill has a drill and clutch mode, set it to clutch mode. Set your drill to 30% of maximum torque.

How to fasten STARTER Clips



1



FASTEN CLIP ON JOIST

Place clip on the joist, centered with the cross joist, and fasten.

2



REPEAT

Install a STARTER Clip at every joist.

3



PLACE BOARD

Tilt board up slightly to set it in the clips.

4



LAY BOARD DOWN

Gently push the board down to lock it in place.

Setup for EDGE Clips



A INSERT T-15 BIT



Insert the T-15 driver bit into your drill. Do not use an impact driver.

B ADJUST DRILL



If your drill has a drill and clutch mode, set it to clutch mode. Set your drill to 30% of maximum torque.

How to fasten EDGE Clips



BEFORE YOU BEGIN

Fasten your first board with CAMO STARTER Clips (p. 17).



1



PLACE CLIP ON JOIST

Place a clip on the joist with the gusset in the groove. Clips stay in place until you're ready to fasten.

2



REPEAT ALONG THE BOARD

Place a clip at every joist along the length of the board.

3



SLIDE ON NEXT BOARD

Place the next board up against the clips, and repeat until you have multiple rows of boards and clips.

4



LOCK-IN YOUR BOARDS

Hold the boards tightly, or lock them in place with CAMO® LEVER®.



5



FASTEN WITH NEVER-MISS GUIDE

Starting at the outermost board, place the NEVER-MISS Guide (included) over the screw head, connect the bit to the head and drive. Repeat until all inner boards are fastened.



OR FASTEN WITH DRIVE (OPTIONAL)

To fasten with DRIVE, starting at the outermost board, put the Clip nose piece over the screw head and drive at full RPM while applying downward pressure. Repeat until all inner boards are fastened. See full instructions on page 10-11.

Setup for EDGEX Clips



A INSERT T-15 BIT



Insert the T-15 driver bit into your drill. Do not use an impact driver.

B ADJUST DRILL



If your drill has a drill and clutch mode, set it to clutch mode. Set your drill to 30% of maximum torque.

How to fasten EDGEX Clips



BEFORE YOU BEGIN

Fasten your first board with CAMO STARTER Clips (p. 17).

1



PLACE CLIP IN GROOVE

Pinch the wings of clip together and slide the clip into the groove. The wings of the clip will expand, holding the clip in place until you're ready to fasten.

2



REPEAT ALONG THE BOARD

Place a clip at every joist along the length of the board.

3



SLIDE ON NEXT BOARD

Place the next board up against the clips, and repeat until you have multiple rows of boards and clips.

4



LOCK-IN YOUR BOARDS

Hold the boards tightly, or lock them in place with CAMO® LEVER®.



5



FASTEN WITH NEVER-MISS GUIDE

Starting at the outermost board, place the NEVER-MISS Guide (included) over the screw head, connect the bit to the head and drive. Repeat until all inner boards are fastened.



OR FASTEN WITH DRIVE (OPTIONAL)

To fasten with DRIVE, starting at the outermost board, put the Clip nose piece over the screw head and drive at full RPM while applying downward pressure. Repeat until all inner boards are fastened. See full instructions on page 10-11.

Setup for EDGEXMETAL Clips



A INSERT T-15 BIT



Insert the T-15 driver bit into your drill. Do not use an impact driver.

B ADJUST DRILL



If your drill has a drill and clutch mode, set it to clutch mode. Set your drill to 30% of maximum torque.

How to fasten EDGEXMETAL Clips



1



PLACE CLIP IN GROOVE

Pinch the wings of clip together and slide the clip into the groove. The wings of the clip will expand, holding the clip in place until you're ready to fasten.

2



REPEAT ALONG THE BOARD

Place a clip at every joist along the length of the board.

3



SLIDE ON NEXT BOARD

Place the next board up against the clips, and repeat until you have multiple rows of boards and clips.

4



LOCK-IN YOUR BOARDS

Hold the boards tightly, or lock them in place with CAMO® LEVER®.

5



FASTEN WITH NEVER-MISS GUIDE

Starting at the outermost board, place the NEVER-MISS Guide (included) over the screw head, connect the bit to the head and drive. Repeat until all inner boards are fastened.



OR FASTEN WITH DRIVE (OPTIONAL)

To fasten with DRIVE, starting at the outermost board, put the Clip nose piece over the screw head and drive at full RPM while applying downward pressure. Repeat until all inner boards are fastened. See full instructions on page 10-11.

CAMO

LEVER®

Build a better deck by yourself with LEVER®, the one-turn tool that locks-in rows of boards and clips and straightens warped boards.

INTRODUCTION

25

BENDING

26

LOCKING

28

DECK BOARD SIDE

TURN

TURN

DECK BOARD SIDE

DOUBLE
JOIST

Get to know your *LEVER* tool



ASSEMBLING YOUR TOOL

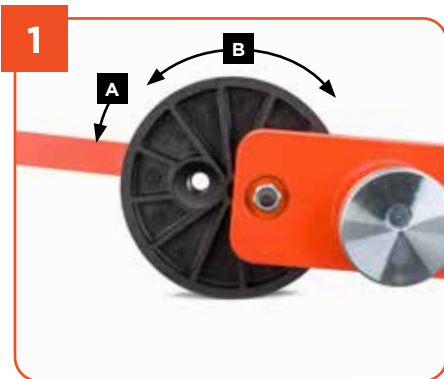

ALIGN

A) Straighten the handle.
B) Align both holes by rotating the board cam.



INSERT SCREW

Insert flathead screw from the bottom of board cam.



TIGHTEN

Use supplied hex key to securely tighten the screw.

Setup for bending boards

A SET THE JOIST TYPE—WOOD OR METAL



Loosen joist knob until the stop block disengages.



Rotate the stop block to the desired side, align the block with the holes, push back into place, and tighten the joist knob.

B SET THE JOIST WIDTH



Adjust the stop block to the proper joist width and tighten the knob.



The Single Joist setting accommodates joists 1-1/2 in. wide. The Double Joist setting accommodates joists 3 in. wide.

How to bend boards



1



SECURE BOARD

Get your board in place and fasten one end.

2



POSITION

Place LEVER on the joist at the opposite end of the board and tighten the joist cam with the pivot pin.

3



BEGIN BENDING

Apply pressure by moving the handle towards the deck board.

4



CLOSE THE GAP

Keep turning until the board is in desired fastening position.

5



FASTEN

Fasten the board.

6

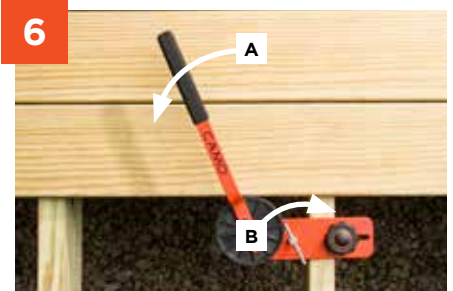

RELEASE & REMOVE

A) Release pressure by moving the handle away from the deck board.
B) Loosen the joist cam and remove LEVER.

Setup for locking boards and Clips

A SET THE JOIST TYPE—WOOD OR METAL



Loosen joist knob until the stop block disengages.



Rotate the stop block to the desired side, align the block with the holes, push back into place, and tighten the joist knob.

B SET THE JOIST WIDTH



Adjust the stop block to the proper joist width and tighten the knob.



The Single Joist setting accommodates joists 1-½ in. wide. The Double Joist setting accommodates joists 3 in. wide.

How to lock boards

For the best experience with consistent board spacing, use 2-4 LEVER tools across the length of the deck.

1



PREPARE BOARDS

Lay down multiple rows of boards and CAMO Universal Deck Clips.

2



POSITION

Place LEVER on the joist and tighten the joist cam with the pivot pin.

3



LOCK-IN

Apply pressure by moving the handle towards the deck board. Do not over-tighten as the boards can buckle.

4



FASTEN

Leave LEVER in place until all clips are fastened.

5



RELEASE

Release pressure by moving the handle away from the deck board.

6



REMOVE

Loosen the joist cam and remove LEVER.

MARKSMAN[®]

Achieve a fastener-free surface on square decking with this easy and affordable hidden fastening system. MARKSMAN Tools automatically establish spacing between boards and direct CAMO Edge Screws into the edge of the board, leaving a smooth deck surface. Plus, the MARKSMAN system is backed by a CAMO warranty for use in leading deck boards.

INTRODUCTION	31
MARKSMAN PRO TOOLS	32
MARKSMAN EDGE	34

CAMO[®]
PRO-X1

Get to know your MARKSMAN® tools

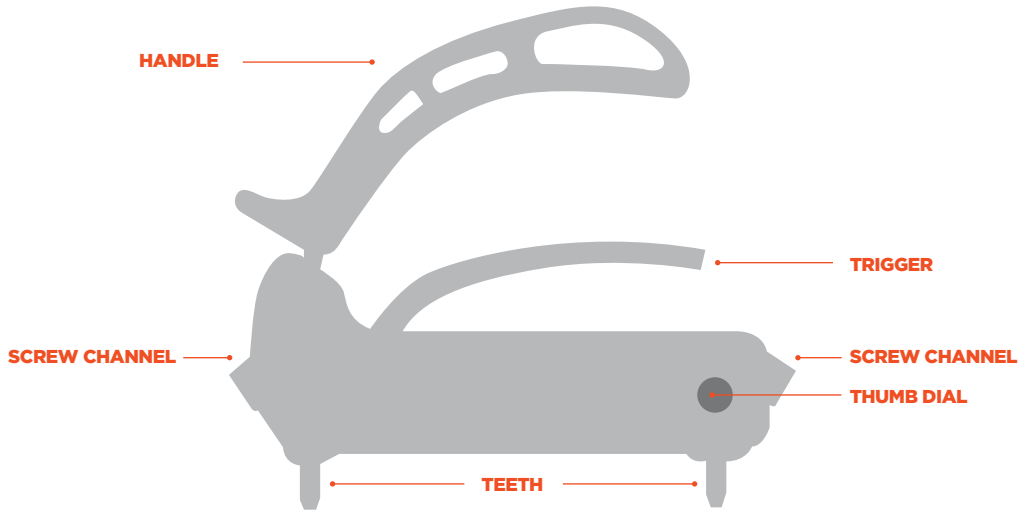

MARKSMAN PRO®



MARKSMAN PRO-X1®



MARKSMAN PRO-NB®

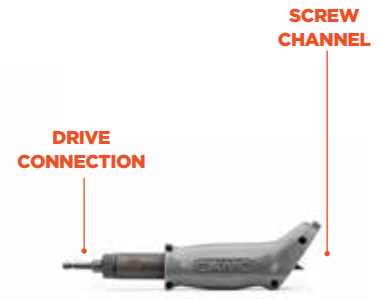

MARKSMAN EDGE

MARKSMAN tools are for exclusive use with CAMO Edge Screws



WHICH TOOL SHOULD I USE?

	MARKSMAN PRO	MARKSMAN PRO-X1	MARKSMAN PRO-NB	MARKSMAN EDGE
Tool				
Gap	3/16 in.	1/16 in.	3/16 in.	None
Board Width	5-1/4 to 5-3/4 in.	5-1/4 to 5-3/4 in.	3-1/4 to 5 in.	Any
Compatible Boards	KDAT Composite PVC Capped Composite (with pre-drilling) Cedar Redwood Hardwood (with pre-drilling)	Pressure Treated	KDAT Composite PVC Capped Composite (with pre-drilling) Cedar Redwood Hardwood (with pre-drilling)	Pressure Treated

Setup for MARKSMAN Pro Tools



A INSERT T-15 BIT



Insert the T-15 driver bit into your drill. Do not use an impact driver.

B IF YOU'RE PRE-DRILLING*, INSERT THE PRE-DRILL BIT



Speed up the job by attaching the pre-drill bit to another drill.*

C ADJUST DRILL



The recommended fastening speed for Edge fastening is 2500 RPM.

D ADJUST SPACER TEETH



Adjust the spacer teeth on the tool with the thumb dial to fit your board.

*Pre-drilling is required for capped composite and hardwoods.

How to fasten Edge Screws

BEFORE YOU BEGIN

Where Edge fastening with the MARKSMAN Pro Tools isn't possible, use CAMO Premium Deck or Composite Screws. Go to page 41 for full instructions.

1



PLACE TOOL

Place the tool on the board so it's in line with the joist. If you are NOT pre-drilling, skip to step 3.

2



DRILL HOLE*

If pre-drilling, run the pre-drill bit through both screw channels*.

***Pre-drilling is required for capped composite and hardwoods.**

3



LOAD SCREWS

Load an Edge screw into both screw channels.

4



DRIVE

Drive the screw in on both sides letting the screw do the work. The shoulder on the bit will stop the screw from overdriving.

Setup for MARKSMAN EDGE

**A**

ATTACH YOUR DRILL



Attach the Drive Connection to your drill.

NOTE: The MARKSMAN EDGE tool leaves no gap between boards. If you desire a gap, place secondary spacers before fastening.

How to fasten Edge screws

BEFORE YOU BEGIN

Where Edge fastening with the MARKSMAN EDGE isn't possible, use CAMO Premium Deck or Composite Screws. Go to page 41 for full instructions.

1



LOAD A SCREW

Load an Edge screw into the magnetized screw channel.

2



PLACE TOOL ON BOARD

Align the screw channel with the joist, ensuring the face of the tool is flat.

3



DRIVE

Drive the screw until it's fully seated in the board.

EXTERIOR

CAMO offers a high-quality line of exterior screws that deliver on reliability no matter the project. Each screw starts fast, holds strong, is ACQ compatible, and is designed to last. We offer Premium Deck, Premium Trim, Composite, and Structural screws that all come with a power bit and are backed by a CAMO warranty against rust and corrosion so you can confidently use them in your decking projects, substructures, landscaping projects, fences, pole barns, and more.

Get to know your Exterior Screws



WHICH SCREW TYPE SHOULD I USE?

RECOMMENDED APPLICATIONS FOR EACH SCREW TYPE	
PREMIUM DECK	<ul style="list-style-type: none"> • Wood decking projects • Fences • Any exterior wood-to-wood connection
COMPOSITE	<ul style="list-style-type: none"> • Composite decking projects • PVC decking projects
PREMIUM TRIM	<ul style="list-style-type: none"> • Decking • Exterior trim • Deck rails • Balusters • Fences
STRUCTURAL	<ul style="list-style-type: none"> • Deck substructure • Deck posts • Beams • Handrails • Landscape timbers

SETUP FOR FASTENING EXTERIOR SCREWS



INSERT BIT

Insert the power bit that was included in the pail of screws into your drill. Do not use an impact driver.

RESOURCES

From Edge fastening in special cases to troubleshooting your DRIVE tool and more, this resource section contains the information you need to tackle any install.

SPECIAL CASES - EDGE FASTENING	39
BEST PRACTICES FOR EDGE FASTENING	41
SPECIAL CASES - CLIP FASTENING	42
EDGE FASTENING RECOMMENDATIONS BY BOARD	44
MARINE ENVIRONMENTS	46
TROUBLESHOOTING	47

Edge Fastening Against a Structure

BY HAND & WITH DRIVE

Given the length of the DRIVE tool and the angle required for installation, you will not be able to Edge fasten both sides of the first few rows of boards next to a structure. In these instances, use CAMO Premium Deck or Composite Screws following the instructions below.

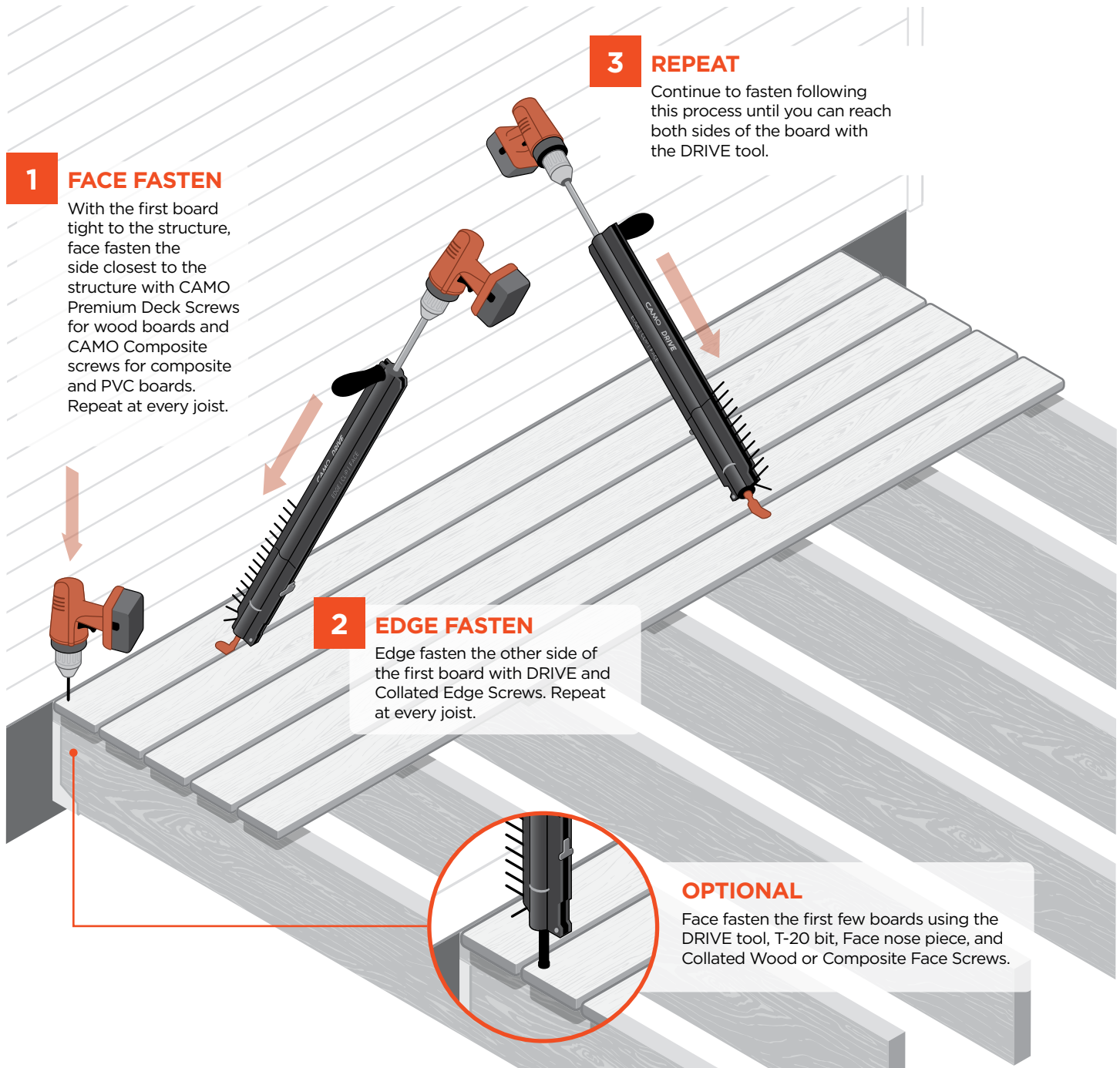

1 FACE FASTEN

With the first board tight to the structure, face fasten the side closest to the structure with CAMO Premium Deck Screws for wood boards and CAMO Composite screws for composite and PVC boards. Repeat at every joist.

3 REPEAT

Continue to fasten following this process until you can reach both sides of the board with the DRIVE tool.

2 EDGE FASTEN

Edge fasten the other side of the first board with DRIVE and Collated Edge Screws. Repeat at every joist.

OPTIONAL

Face fasten the first few boards using the DRIVE tool, T-20 bit, Face nose piece, and Collated Wood or Composite Face Screws.

Edge Fastening Against a Structure

MARKSMAN TOOLS

Given the drill angle required for installation with the MARKSMAN Pro Tools, you will not be able to Edge fasten both sides of the first board next to a structure. In these instances, use CAMO Premium Deck or Composite screws, following the instructions below.

1 FACE FASTEN

With the first board tight to the structure, face fasten the first board with CAMO Premium Deck Screws for wood boards and CAMO Composite screws for composite and PVC boards. Repeat at every joist.

2 BEGIN EDGE FASTENING

Once you can fit your drill on both sides of the MARKSMAN tool, start Edge fastening the board.

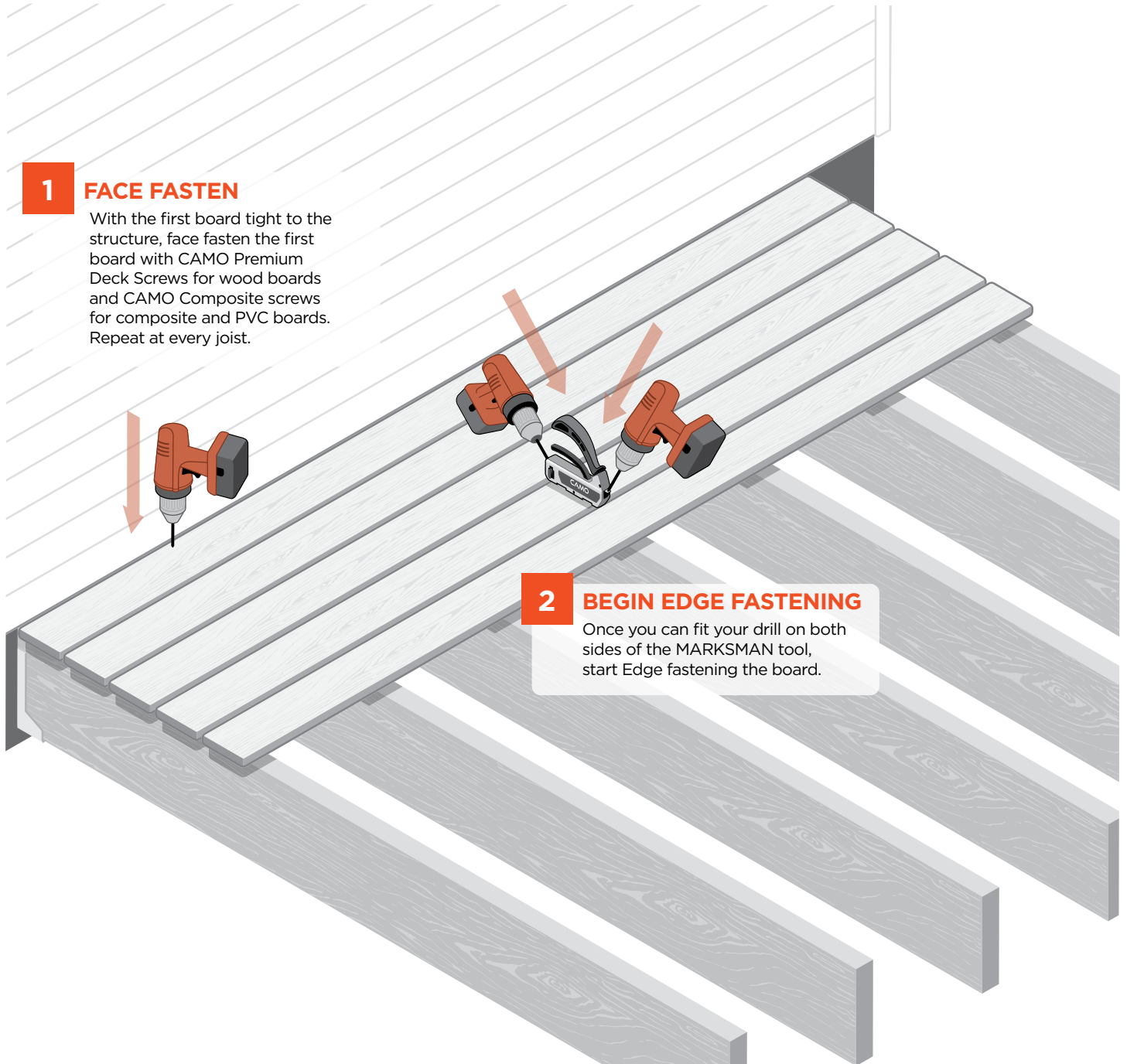

Best Practices for Edge Fastening

! Failure to install CAMO Edge Screws in accordance with this installation guide may affect fastener performance and void product warranty.

! CAMO Edge Screws are intended for attaching deck boards directly to deck substructure using CAMO tools. Any other use is not recommended or covered by warranty.

GUIDELINES FOR EVERY EDGE FASTENING INSTALLATION

DECK SLOPE:

Your deck surface should be sloped a minimum of 1/4 in. per 12 feet of horizontal run to allow for moisture run-off.

AIRFLOW/DRAINAGE:

You must have unobstructed airflow under 50% of the deck to allow for sufficient cross-ventilation from one side to the other. This allows the underside of the deck structure to dry and prevents heat build-up. Never install a deck directly over any solid surface, such as concrete.

INSTALL DOUBLE (SISTER) JOISTS:

A double joist is required at butt joints where two board ends meet on the deck surface.

FROWN DOWN:

When you look at the wood deck board ends, you will see the lumber's growth rings. Make sure those rings are facing downward—the direction of a frown—when laid flat on the joists for fastening. This will reduce the natural tendency for the board to cup upward when it dries.

FASTENING:

- Do not fasten within 1 in. of the deck board ends.
- Use two screws on every board at each joist location.
- Do not force the Edge screw. Allow the Edge screw to scrape and auger the surface with light pressure, which allows the Edge screw to enter the board without splitting.
- Never use CAMO Edge screws to attach decking to a floating substructure.

SELECTING THE RIGHT EDGE SCREW

Edge screws are available in two sizes:

- 1-7/8 in. for boards 1 in. thick or less
- 2-3/8 in. for boards thicker than 1 in.

Edge screws are available in ACQ Compatible ProTech Coating and 316 Stainless Steel.



DECK BOARD MATERIAL	RECOMMENDED CAMO EDGE SCREW
Pressure Treated Lumber	Stainless Steel or ProTech Coated
Composite	Stainless Steel or ProTech Coated
Capped Composite	Stainless Steel or ProTech Coated (with pre-drilling)
PVC	Stainless Steel or ProTech Coated
Cedar	Stainless Steel Required
Redwood	Stainless Steel Required
Hardwood or Imported Hardwood	Stainless Steel Required (with pre-drilling)

Recommendations by Board



PRESSURE TREATED

Twisting, warping, cupping, and splitting are expected performance attributes with pressure treated decking in its wet/green state. Following the guidelines presented will reduce, but not eliminate, the normal behavior of pressure treated deck boards.

- **Board Spacing:** Typical pressure treated decking (moisture content above 19%) needs little to no spacing between boards at the time of installation. As the boards dry, they will shrink, creating a space naturally.
- **Installing on Sleeper Systems:** CAMO Edge Screws are not recommended for sleeper systems using treated lumber.
- **Recommended CAMO Tools:**
 - DRIVE™ (no gap)
 - MARKSMAN® EDGE (no gap)
 - MARKSMAN Pro®-X1 (1/16 in. gap)



PVC & COMPOSITE DECKING

Air temperature variation results in the expansion and contraction of various boards, including PVC and composite. Following the guidelines presented will ensure the best installation and reduce problems associated with board movement.

- **Board Spacing:** Always review and follow your deck manufacturer's gap and spacing requirements for deck board installation. These requirements can vary by manufacturer and installation temperature and environment.
- **Installing on Sleeper Systems:** You must allow a 1-½ in. minimum of unobstructed airflow beneath the deck on both ends in the direction that the joist runs and have at least 3/16 in. board spacing.
- **Recommended CAMO Tools:**
 - MARKSMAN Pro® (3/16 in. gap)
 - DRIVE™ (with secondary 3/16 in. spacer)



KDAT (KILN DRIED AFTER TREATING)

Twisting, warping, cupping, and splitting are expected performance attributes with KDAT decking. Following the guidelines presented will reduce, but not eliminate, the normal behavior of pressure treated deck boards.

- **KDAT weatherization treatment:** KDAT must always be sealed with a water repellent with UV protection before or immediately after installation.
 - Stain: Use a penetrating stain with water repellent and UV stabilizer.
 - Paint: Use an oil-based primer followed by two coats of latex (acrylic) paint.
- **Board Spacing:** Install KDAT decking with a minimum of 3/16 in. spacing between boards. KDAT boards are installed in a thirsty state and will expand slightly as they are exposed to moisture.
- **Installing on Sleeper Systems:** You must allow a 1-½ in. minimum of unobstructed airflow beneath the deck on both ends in the direction that the joist runs.
- **Recommended CAMO Tools:**
 - MARKSMAN Pro® (3/16 in. gap)
 - DRIVE™ (with secondary 3/16 in. spacer)

When you require the use of secondary spacers, use a couple of MARKSMAN tools to properly space your boards before fastening with DRIVE. They also come in handy in tight fastening situations.

Recommendations by Board



CAPPED COMPOSITE

Air temperature variation results in the expansion and contraction of various boards, including capped composite. Following the guidelines presented will ensure the best installation and reduce problems associated with board movement.

- **Board Spacing:** Always review and follow your deck manufacturer's gap and spacing requirements for deck board installation. These requirements vary depending on the specific board material.
- **Installing on Sleeper Systems:** You must allow a 1-½ in. minimum of unobstructed airflow beneath the deck on both ends in the direction that the joist runs and have at least 3/16 in. board spacing.
- **Recommended CAMO Tools:**
 - MARKSMAN Pro® (3/16 in. gap)
- **Pre-drilling is Required:** Use the pre-drill process when installing capped composite boards to eliminate mushrooming and splitting.
 - Use CAMO 3/16 in. pre-drill bit (item #345035) with your MARKSMAN Pro Tool in place on the deck board.



You can also use your own 3/16 in. drill chucked at 2-¾ in. from the nose of the drill

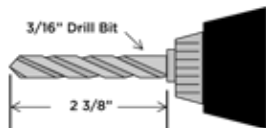

CEDAR AND REDWOOD

Cedar and Redwood are stable deck boards. They naturally resist moisture which causes splitting, twisting, and cupping. Following the guidelines presented will ensure the best performance.

- **Board Spacing:** We recommend 1/8 in. to 1/4 in. spacing between boards at the time of installation.
- **Installing on Sleeper Systems:** You must allow a 1-½ in. minimum of unobstructed airflow beneath the deck on both ends in the direction that the joist runs and have at least 3/16 in. board spacing.
- **Recommended CAMO Tools:**
 - MARKSMAN Pro® (3/16 in. gap)
 - DRIVE™ (with secondary 3/16 in. spacer)



TROPICAL HARDWOOD

Twisting, warping, and cupping are common performance attributes with hardwood decking. Following the guidelines presented will reduce, but not eliminate, the normal behavior of hardwood deck boards.

- **Acclimating:** Tropical hardwood decking needs to be acclimated to the environment prior to installation.
 - We recommend that the boards be on-site at least 7 days prior to installation.
 - Do not store directly on the ground or on top of concrete. Decking should be elevated at least 12 in. off the ground.
 - Cover the material with a sheet of plywood to keep it dry until installation. Do not use a tarp or plastic as a cover as both can trap moisture.
 - Place 1 in. x shims/stickers between the rows of boards to allow for airflow.
- **Board Spacing:** A minimum of 1/16 in. spacing is required to allow for expansion and contraction. Expect 1/8 in.-1/4 in. of side-to-side board shrinkage.
- **Installing on Sleeper Systems:** Typical sleeper systems will not meet the minimum airflow requirements for hardwood installation, so they are not recommended.
- **Cutting:** Board ends should be sealed with end grain sealant within 24 hours of cutting.
- **Recommended CAMO Tools:**
 - MARKSMAN Pro® (3/16 in. gap) for the best experience
 - MARKSMAN Pro®-X1 (1/16 in. gap) for minimal spacing
- **Pre-drilling is Required:** Use the pre-drill process when installing hardwood boards to eliminate pushout and splitting.
 - Use CAMO 3/16 in. pre-drill bit (item #345035) with your CAMO MARKSMAN Pro or Pro-X1 Tool in place on the deck board.



You can also use your own 3/16 in. drill chucked at 2-¾ in. from the nose of the drill

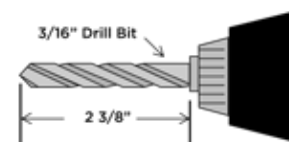

Installing at Butt Joints



ALWAYS INSTALL A DOUBLE JOIST AT THE BUTT JOINTS

Use a separate clip to secure each board end. Please follow your deck board manufacturer's instructions for end-to-end board gapping distance to allow for expansion and contraction at this joint.

EDGE Clips

1



REMOVE LEGS ON EDGE CLIP

You will need 4 clips for each butt joint. Remove the legs of the Clip so that they can sit side-by-side on the double joists.

2



FASTEN SCREWS

With boards positioned correctly, place the clips in the groove, centered on joists on both sides of the boards. Partially fasten the screws to hold them in place until next board is set, then fully fasten the screws.

EDGEEX & EDGEEXMETAL Clips

1



PLACE 4 CLIPS

Place 4 Clips centered on joists on both sides of the boards.

2



FASTEN SCREWS

Place the next board up against the clips, then fasten the screws.

Replacing Boards If Needed

1



BACK OUT SCREWS

Back out all of the screws from the joist on both sides of the board.

2



PULL UP BOARD

Pull up on the board to easily remove it.

3



LAY NEW DECK BOARD

Clean away any clips remaining on the joists and lay the new deck board in position without any clips in place.

4

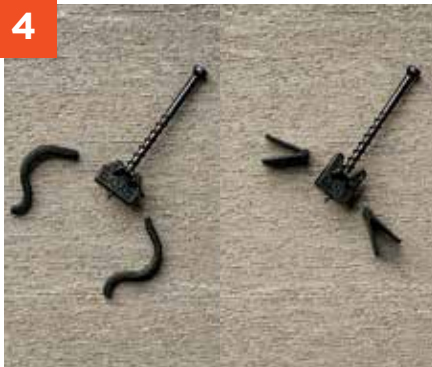

REMOVE LEGS OR WINGS

Count the number of clips needed and snap off the legs or wings on each clip.

5



SLIDE CLIPS DOWN GROOVE

Slide the clips (screws and gussets) down the groove positioning one over each joist on both sides of the board.

6



FASTEN AT EACH JOIST

Fasten clips securely in place using the NEVER-MISS™ Guide.

Installing in Coastal Waterways and Marine Environments



Failure to install CAMO fasteners in accordance with this installation guide may affect fastener performance and void product warranty.

NOTE: For maximum corrosion resistance in every installation, use CAMO fasteners made of 316 Stainless Steel.

Saltwater environments can create an environment of severe rust and corrosion. Proper fastener selection is critical to avoid both structural failure and diminished aesthetic quality of the fasteners. Fasteners subjected to direct contact with saltwater or are within a 10-mile reach of exposure to aerosolized saltwater carried by the wind from breaking waves are susceptible to highly increased corrosion rates.

THE FOLLOWING ARE REQUIREMENTS AND AVAILABLE CAMO FASTENERS FOR YOUR INSTALLATION.

Within 3000 feet of the shoreline: 316 Stainless Steel fasteners are required

- Collated Edge Screws—316 Stainless Steel (for use with DRIVE™)
- Edge Screws—316 Stainless Steel
- Composite Screws—316 Stainless Steel (color-matched available)
- Premium Deck Screws—316 Stainless Steel
- Premium Trim Screws—316 Stainless Steel (color-matched available)

3000 feet to 10 miles from the shoreline: Stainless Steel fasteners are required

- EDGE® Clip
- EDGEX® Clip
- EDGEXMETAL® Clip
- STARTER Clip
- Collated Composite Screws—304 Stainless Steel Bright (for use with DRIVE)
- Premium Deck Screws—305 Stainless Steel

Troubleshooting

REMOVING COLLATED SCREWS FROM DRIVE



SLIDE PICKER

Slide the picker up to the nose piece to release tension.



REMOVE STRIP

The strip should easily pop free, or you can pull it out.

UNJAMMING COLLATED STRIPS



RELEASE STRIP

Slide picker up to release the strip from the picker.



BACK OUT OR TEAR STRIP

If possible, back out the strip from the nose piece. If you can't back it out, tear the strip away from the jammed fastener.



REMOVE NOSE PIECE

Remove the nose piece to ensure it's clear of fasteners.



REATTACH

Insert the nose piece again.



RELOAD

Load a new strip of screws.

WHEN TO CHANGE THE BIT



DRIVER BITS AND THE BIT HOLDER WILL WEAR OVER TIME.

If you hear a grinding sound while driving, the bit may be slipping in the bit holder

- Check the bit tip for wear and replace it if it's worn.
- If the bit tip is fine, check the bit at the top where it locks into the bit holder.
- If there is a wear line at the top of the bit, it's time to change the bit holder.

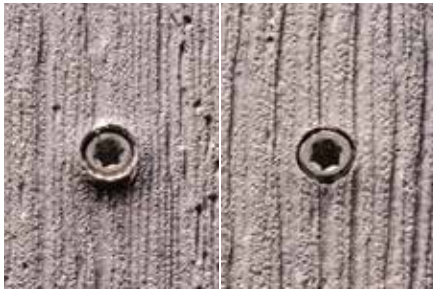

If you're experiencing screws not driving fully flush:

- Check the depth dial—it's possible it was bumped.
- Make sure you're using the correct bit.
- Check the bit tip for wear and replace it if it's worn.
- If there is a wear line at the top of the bit, it's time to change the bit holder.



We do not recommend the use of impact drivers as they will cause driver bits to wear quickly and even crack.

BOARDS ARE CRACKING WHEN FASTENED



Edge Fastening

- If you are applying too much pressure on the drill it prevents the screw from boring the material. This can cause screw slipping and mushrooming with PVC and composite boards, or cracking and splitting of wood boards.
- Solution: let the rake tip on the screw auger the material out—do not force it.

Composite Face Fastening

- If you are applying too much pressure, the composite boards can mushroom and crack.
- Solution: let the sharp point of the screw do the work of biting into the board—do not force it. Additionally, the trilobular shank will reduce torque and prevent mushrooming.

CLIP SCREWS ARE STRIPPING

Excessive torque can cause over-driving, resulting in screw spin-out or stripping. Be sure your drill (not impact driver) is set to 30% of maximum torque. Also, be sure to check the tip on your bit for wear if screws continue to strip and replace it if it's worn.



CAMO[®]
The Better Way to Build a Deck