

Installing Quick-Connect® Expansion Anchor

The Expansion Anchor Fitting is comprised of a Quick-Connect® body and a stainless steel Expansion Anchor Bolt. Install the Anchor prior to attaching the Quick-Connect® body. **DO NOT** attempt to install the Anchor Bolt with the Quick-Connect® Fitting attached, or you may damage the fitting.



1 Drill 1/4" hole with masonry bit to 1-1/2" (minimum) depth. Blow debris out of hole.



2 Carefully tap the Expansion Bolt until the machine threads protrude 3/4".



3 Tighten nut to set the anchor. Apply a high strength thread locking compound to threads. Spin Quick-Connect® fitting onto Expansion Bolt until it bottoms out.

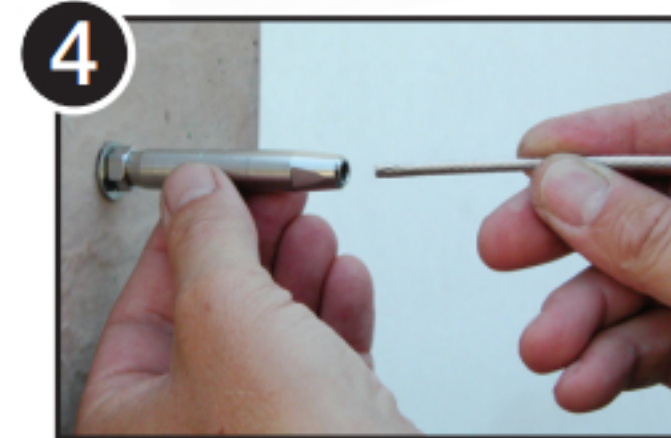

4 Insert cable all the way into Quick-Connect® fitting until it stops. Jaws will lock automatically.

Installing the Quick-Connect® Expansion Anchor Swivel Turnbuckle



1 Drill 1/4" hole with masonry bit to 1-1/4" (minimum) depth. Blow debris out of hole.



2 Carefully tap the Expansion Anchor (with washer and anchor nut).

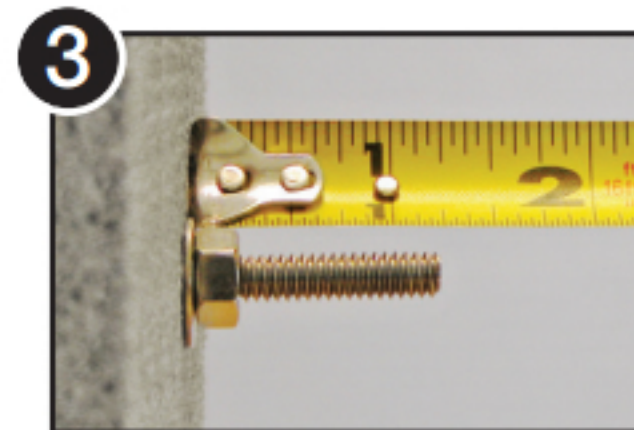

3 Tap until approximately 1-1/4" of the threaded shaft protrudes from the wall.



4 Use 7/16" wrench to tighten anchor nut until anchor is properly seated and locked.

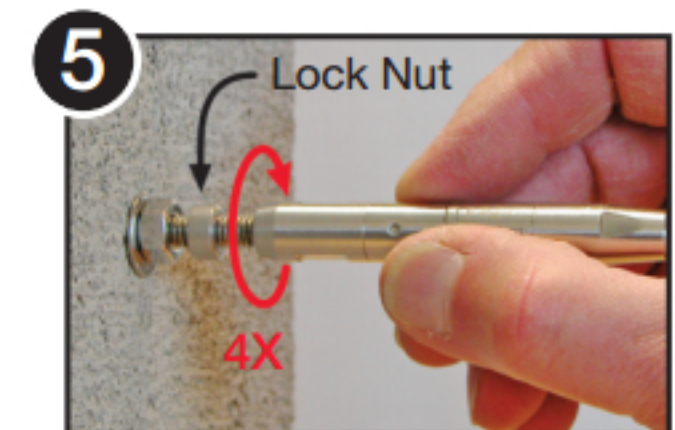

5 Spin the turnbuckle lock-nut onto the exposed threads. Then attach Quick-Connect® and rotate the body 4 full turns.

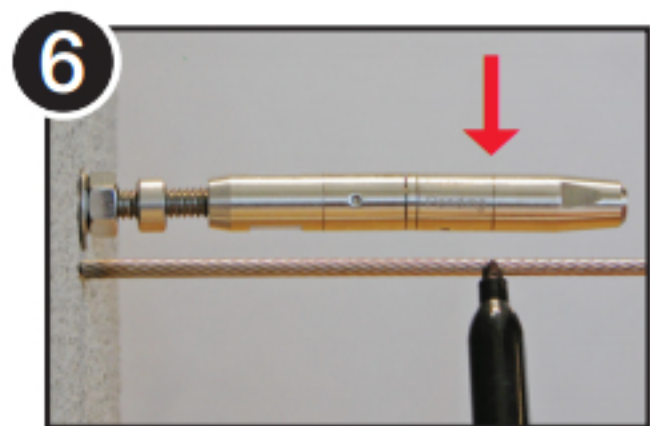

6 Stretch cable tight across fitting and mark at Cut Gauge Line. Cut cable at mark.

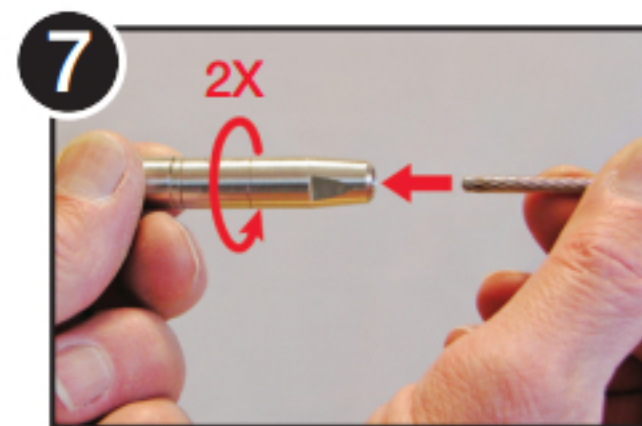

7 Loosen Quick-Connect® 2 full turns and insert cut cable end as far as it will go into the fitting; the jaws will automatically lock on.

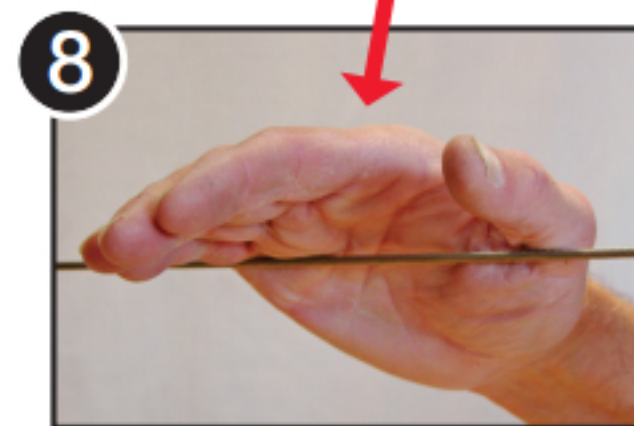

8 Hand tighten the turnbuckle as far as possible, then swiftly hit the cable line with your palm several times to ensure that jaws are securely seated.



9 Use wrenches to tighten the Turnbuckle to desired final tension.



10 Tighten the lock-nut against the swivel component to prevent the fitting from loosening.