

LIGHT FIXTURES

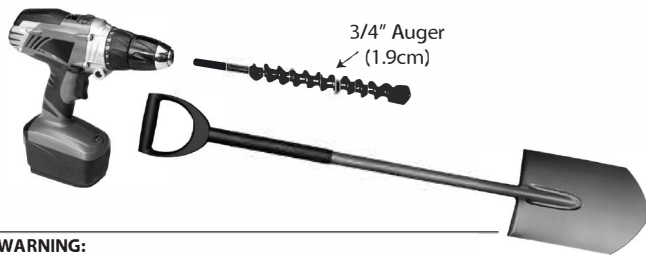

POTENTIAL TOOLS NEEDED



PLUG-N-PLAY CONNECTORS



WARNING: BEFORE ANY DEKOR® LANDSCAPE LIGHTING IS INSTALLED, IT IS THE INSTALLERS RESPONSIBILITY TO ENSURE THAT ALL UNDERGROUND UTILITIES/ LINES ARE LOCATED (GAS LINES, ELECTRICAL LINES, DATA LINES, WATER LINES, ETC.) PRIOR TO ANY WORK BEING DONE. BEFORE YOU DIG - CALL 811

HELPFUL TIPS

- » Follow the appropriate building and electrical codes when installing all DEKOR® lighting products.
- » It is up to you the customer to decide where lighting components are placed. Depending on the distance between lights and/or splitters, the EZPLUGNPLAY HD wire is available for purchase in 5', 10' and 20' lengths. This wire is approved for direct burial use.
- » Leave wire slack to make fixture terminations. Remember slack will be required to properly bury wire.
- » All DEKOR® landscape lights have male connectors. This allows you to connect all the lights together in one run with the purchase of a Plug-N-Play "T" Splitter or EZ Plug-N-Play 6-Port Splitter. You can purchase female to female connectors to connect distances longer than 20'.
- » Use only a standard household AC GFCI protected outlet to help prevent damage from power surges or lightning.
- » When using timer, ensure it is in full view of the sun when using the dusk/dawn feature. Timer must be installed with output plugs facing down, 1.5 ft above the ground, timer is only rain proof.
- » To ensure all components are in working condition it is recommended to have power source attached when installing lights.
- » When burying wire in live sod use spade shovel to make a slit in the soil. Bury the wire 1"-3" (2.5 cm - 7.6 cm) deep and tamp down the soil. Water heavily to allow the soil to resettle and minimize impact on the installation site.

CAUTION:

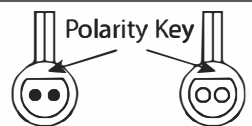

When making a connection between a Plug N Play connector or a splitter; observe the polarity key to make the proper connection. The male and female connectors have a flat side that **MUST MATCH UP. DO NOT** force the connectors together.

DEKOR® LANDSCAPE LIGHTING

Installation Instructions



How to Install DEKOR® Landscape Lighting

(Empress, Ginny, Mushroom, Puck, Radiance, Sidewalk, Spot Light, Telescoping Spot, and Well Lights)

- » ALWAYS check local codes before beginning your project.
- » USE DEKOR® TRANSFORMERS ONLY. Using any other type of transformer voids the warranty.

TRANSFORMER CAPACITY BY TYPE		
Type of Light	5A Transformer EZ Max Transformer	2.5A Transformer EZ Transformer
Mushroom/Radiance/Sidewalk	33	20
Empress	40	24
Ginny	33	20
Puck Light/Well Light	40	23
Spot Light/Telescoping Spot	14	8

Above listing is for maximum number of each individual types of lights. If mixing and matching lighting, contact DEKORLIGHTING.com to determine if more than one transformer is required.
NOTE: Calculations include 100' of wire run resistance.



1 Locate placement of lights and lead wiring. If you choose to bury wire, under concrete or other permanent structures, plan accordingly.



2 Place all lights in desired location. If necessary use 3/4" (1.9 cm) auger with in a drill to penetrate the surface enough to ensure the fixture is firmly implanted. (See warning on Page 1).

BEFORE YOU DIG - CALL 811

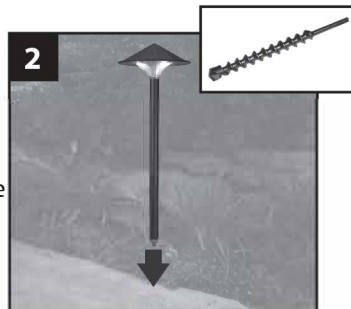

3. Run all wires from the power source locations to the lights on top of the soil, remember to leave slack. If using separate circuits with independent dimmers, we recommend grouping lights by light type. DEKOR® EZ Plug-N-Play HD wire is available in 5 ft, 10 ft, and 20 ft lengths. With the use of Plug-N-Play female-to female, T-splitter and the multi-port splitter, you can create varied lengths needed. Contact Customer Care for specific information when it comes to power loss with regards to extra-long runs.

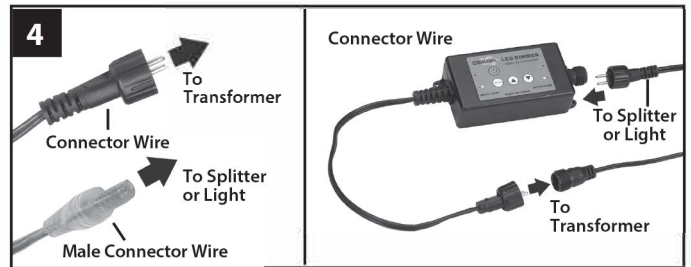

4. Connect all lights. Then connect the optional dimmer (recommended) between the main 20' (6.1 m) transformer male to male lead and the transformer for each circuit. Make sure connections, fixtures, and power sources (including splitters) are all working.

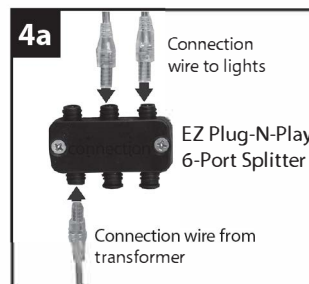

4a. Use EZPLUGNPLAYHD wire to make connections to splitters (all sold separately).

4b. Cap off all unused female connections on splitters using caps that are provided.

5. Connect opposite end of male connector wire to a port on the multi-port splitter that is connected to the transformer or dimmer. (continued next page)

How to install DEKOR® Landscape Lighting / continued

- You can mix and combine all lights on the same circuit but make sure you do not exceed the maximum number of lights per transformer. If running separate circuits with dimmers on each circuit, using a separate transformer for each circuit can simplify installation. However, use of a 5-way splitter will allow for separate circuits on the same transformer.
- When adding male-to-male connector wire extension use a female-to-female adapter. Connect male lead from light to one end of the female-to-female adapter. Add male lead from extension to the other end of the adapter.

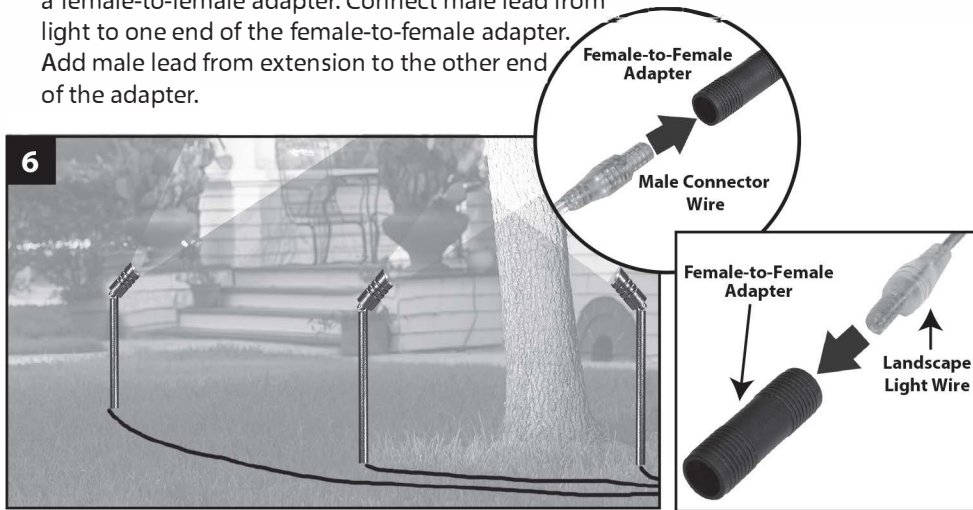

- It is recommended the installer preview light placement in the dark to ensure desired effect is achieved. Test lights to ensure power supply, connections, and light fixtures all work properly and placement is appropriate.
- Once the light, wire, and splitter placement is finalized, work from the light fixtures towards the power source to bury the wire to the desired depth. Ensure that lights are all working with all wiring attached prior to burying any wire. No more than 1"-3" (2.5 cm - 7.6 cm) is required.

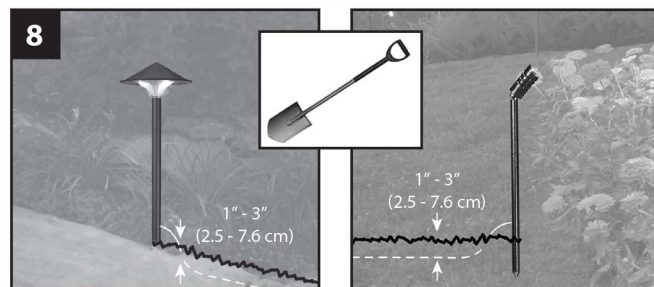

NOTES:

- » DO NOT LOOK DIRECTLY INTO SPOTLIGHT WHEN ON, THIS LIGHT IS VERY STRONG.